

GLASSLINE

Product overview

BALUGA *easy*

Modular aluminium railing system
for easy installation

BALUGA *easy*

- ✓ **Lightweight modules made of aluminium without welds**
- ✓ **"Online System Configurator"**
The fast way to your railing
- ✓ **Large stock program - short delivery times**
- ✓ **LGA-tested safety with tested type statics**
- ✓ **Multidimensional tolerance compensation***
- ✓ **Smooth high quality aluminium surface**
- ✓ **No visible screw connections***
- ✓ **Concealed cable routing for e.g.B. Solar modules**
- ✓ **Screw on and connect modules - done!**
- ✓ **Also available as a French balcony**
- ✓ **RAL colours as requested**



With approved
type statics



LGA-tested
safety

*with connection from the side

Your balcony - quickly configured



1

Dimensions

Enter main dimensions

2

Select structure connection

Structure connection from top or from the side

3

Railing height

Select post height

4

Handrail

Rectangular or semicircular

5

Colour

Select colour

Your balcony

Configure now



Structure connections

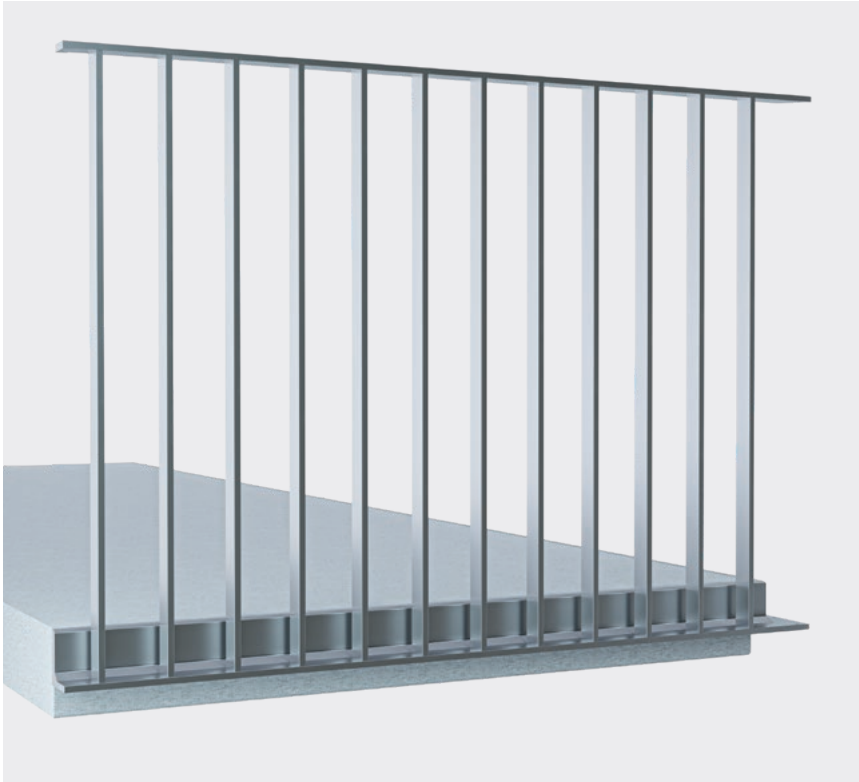

Side installation

Structure connection from the side

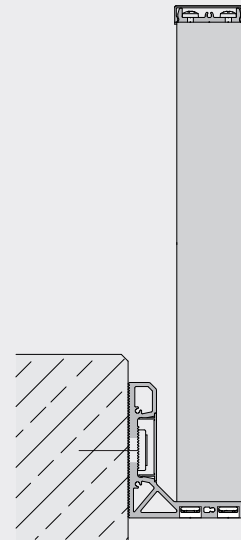

Page 10

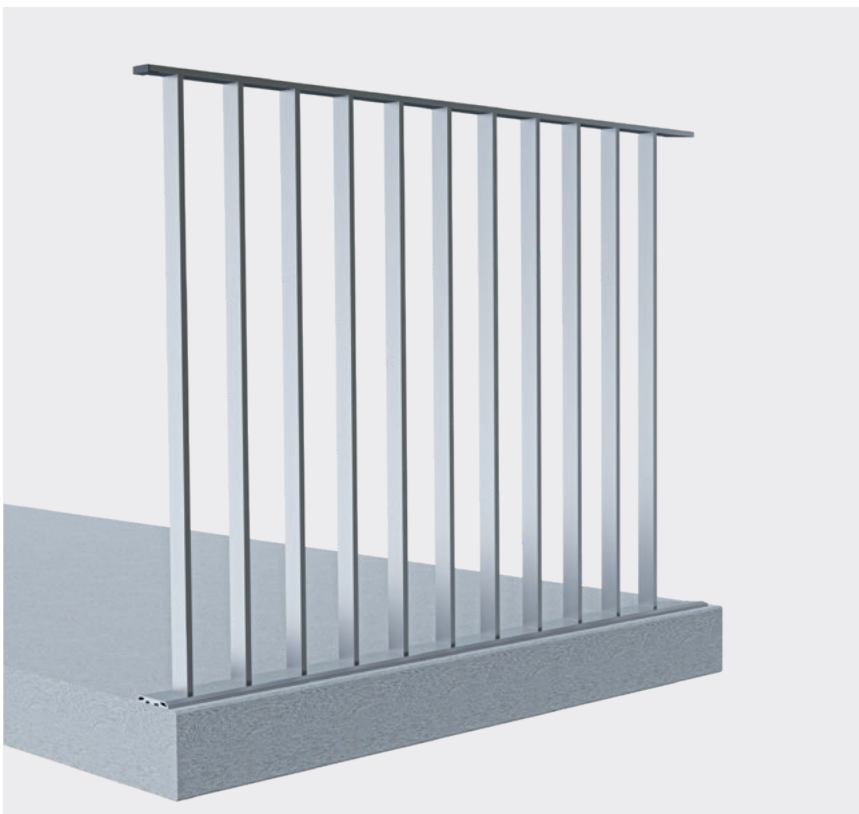

Top installation

Structure connection on top

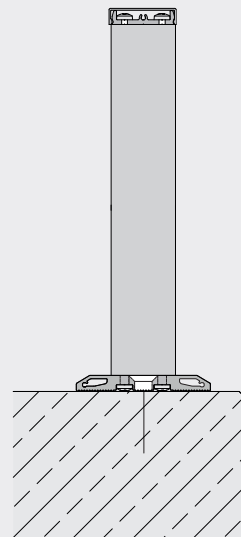

Page 12

Thermal substructure

vertical

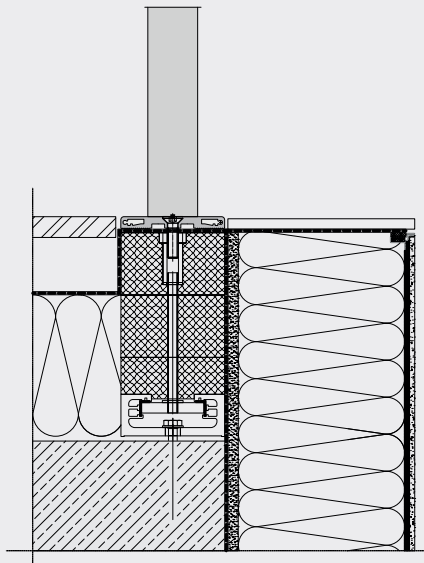

horizontal

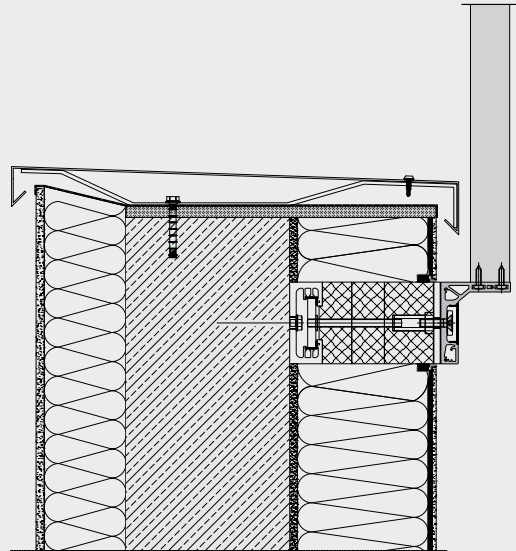

FIX'n SLIDE® system from Glassline



French balconies

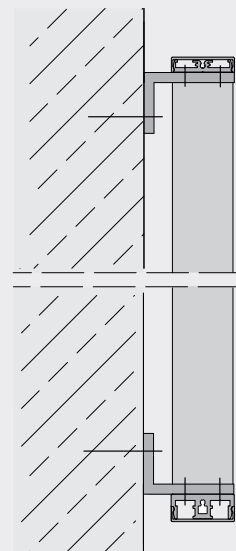

Tolerance compensation

Multidimensional adjustability in the substructure

The building connection elements enable multidimensional and precisely adjustable adjustability on the substructure. The positioning is fixed force-fittedly via the interaction of grooved components, but can be corrected at any time.

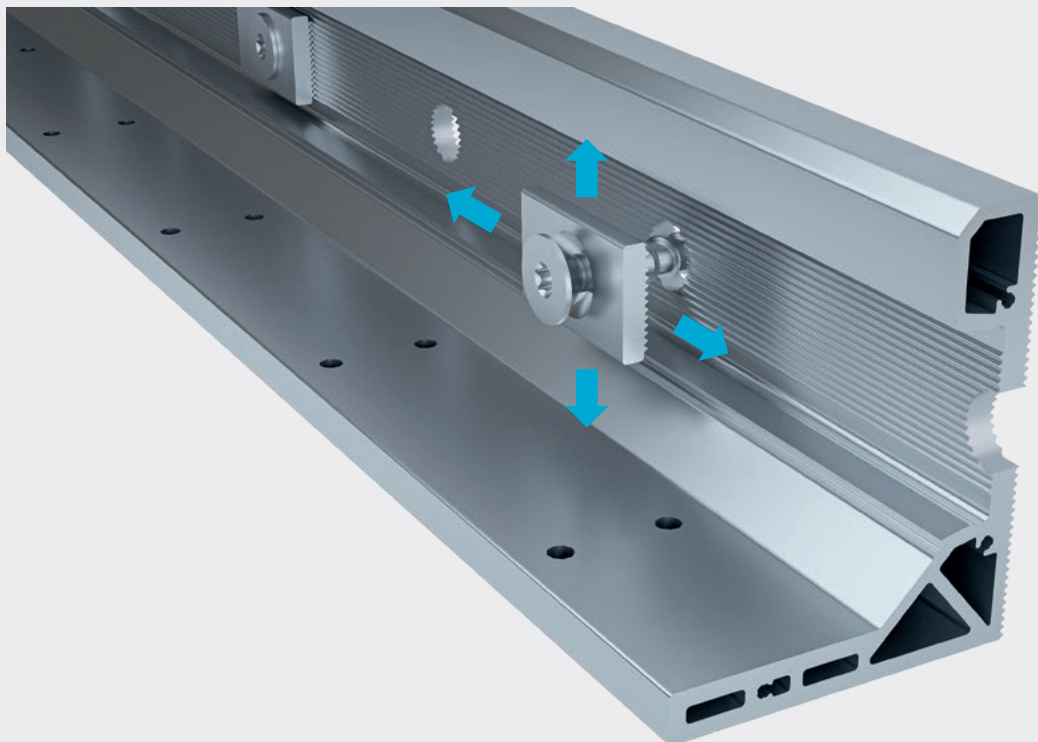

Modular construction

Standard module

Easy handling with a max. module weight of 28 kg

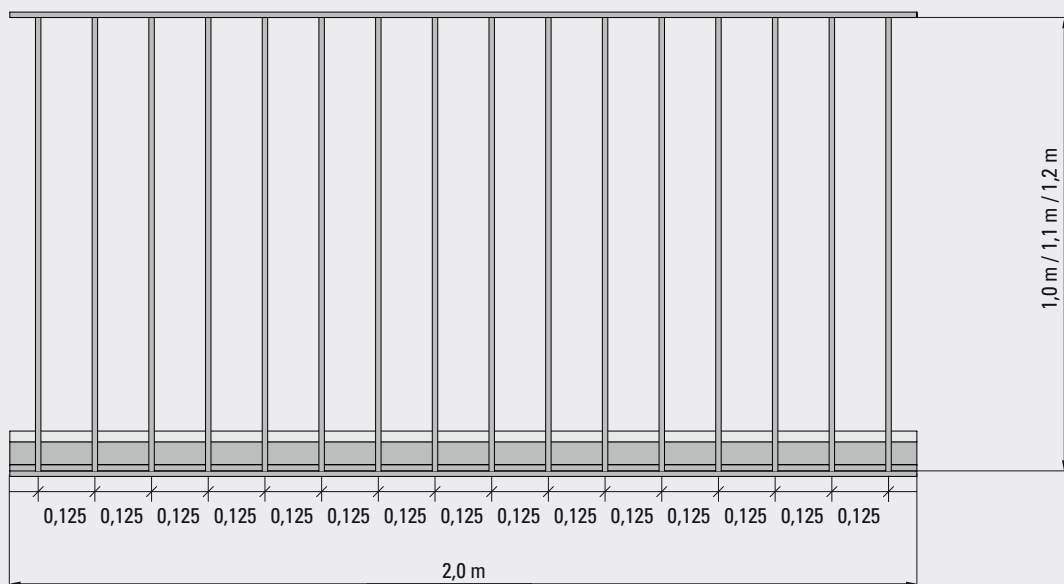

Customised module

Length-adjusted



GLASSLINE

BALUGA *easy*



GLASSLINE

BALUGA *easy*



Side 1

from Bottom

Side installation

Structure connection
below from the side

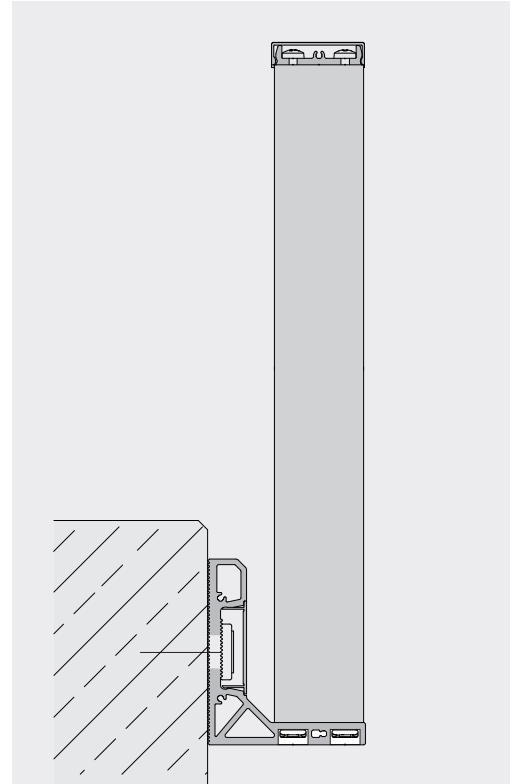
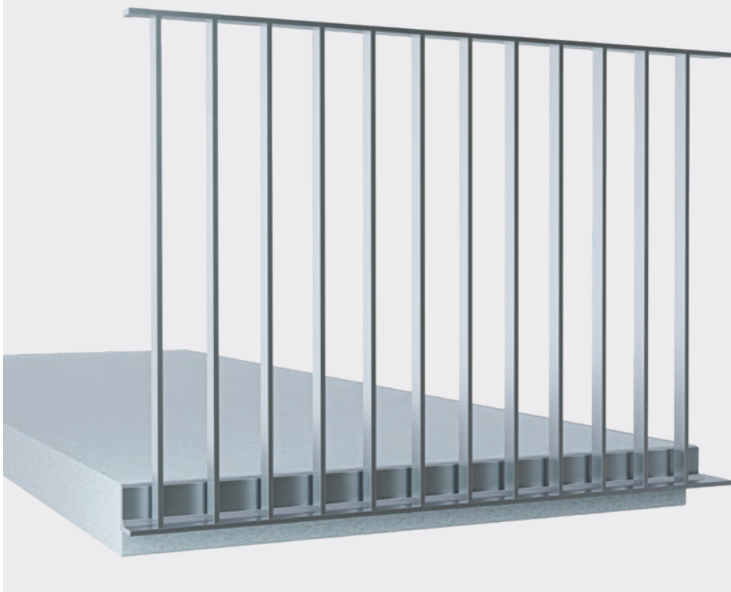

Base profile with cover plate

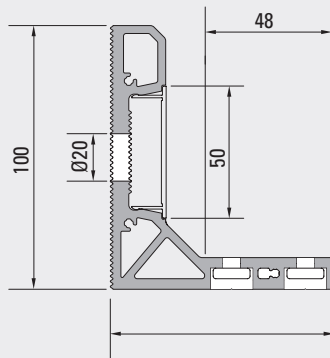

End plate for base profile

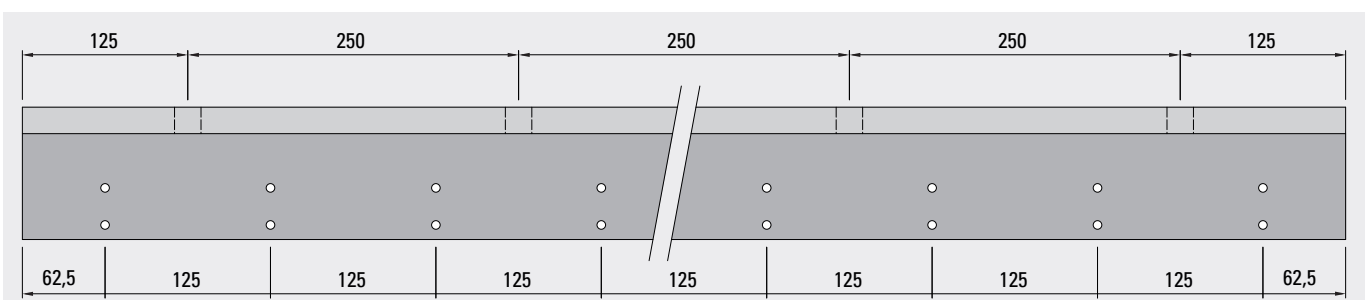

System components

Rectangular handrail

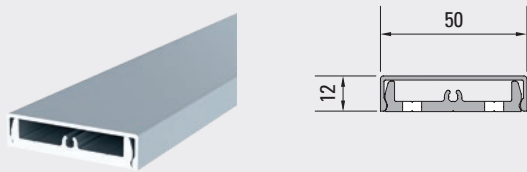

Semicircular handrail

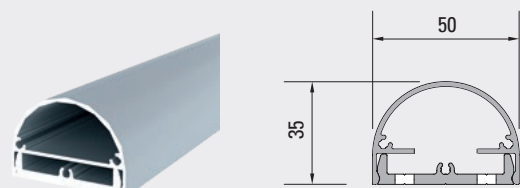

Rectangular railing rod



Semicircular railing rod

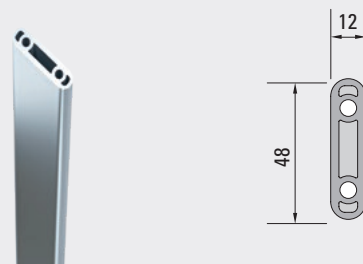

End plate for rectangular handrail

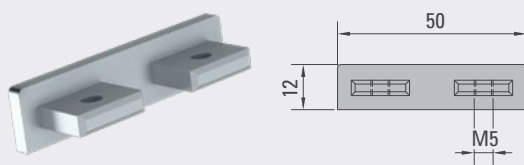

End plate for semicircular handrail

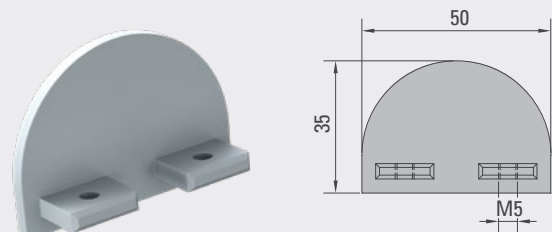

Washer

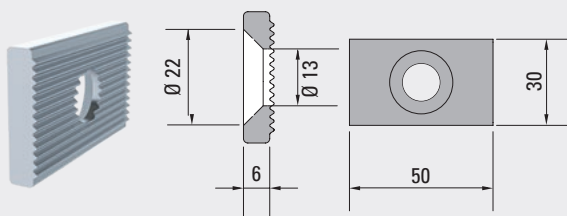

Connector

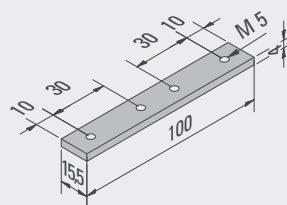

Corner connector

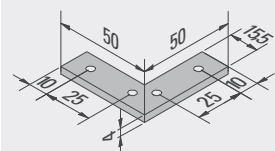

Side 1

from Top

Side installation

Structure connection
above from the side

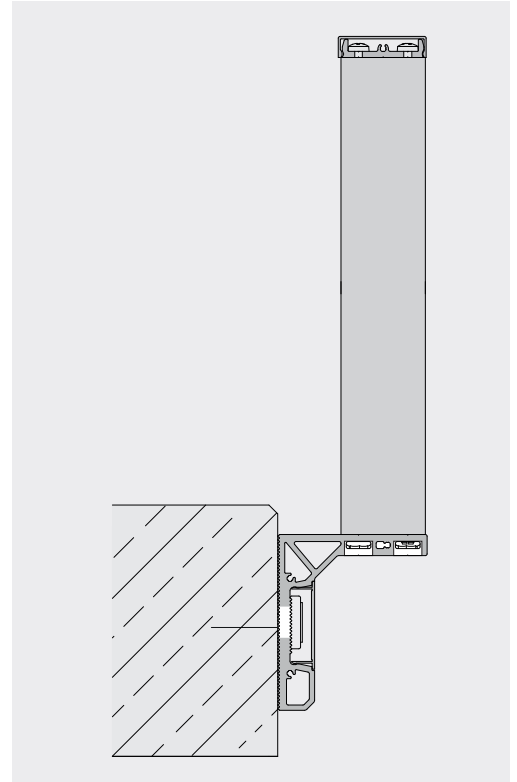

Base profile with cover plate

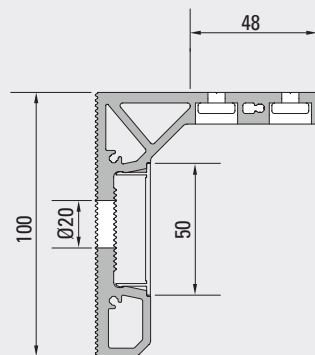

End plate for base profile

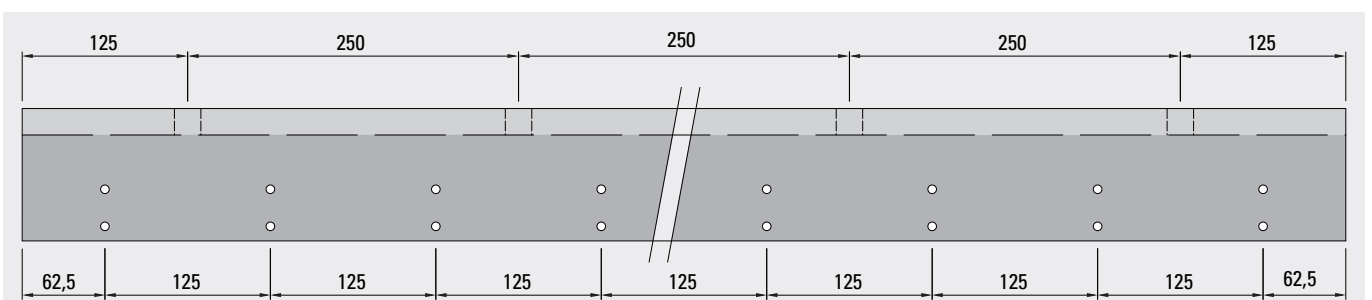

System components

Rectangular handrail

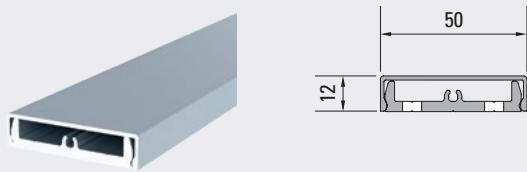

Semicircular handrail

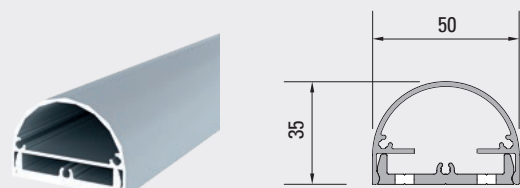

Rectangular railing rod



Semicircular railing rod

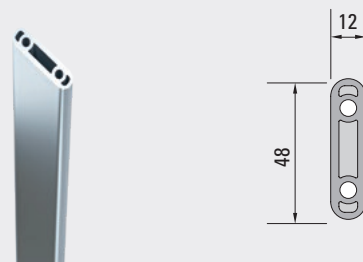

End plate for rectangular handrail

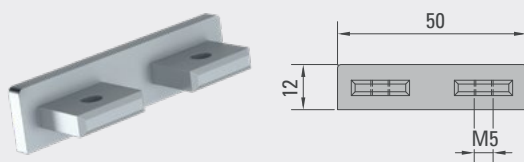

End plate for semicircular handrail

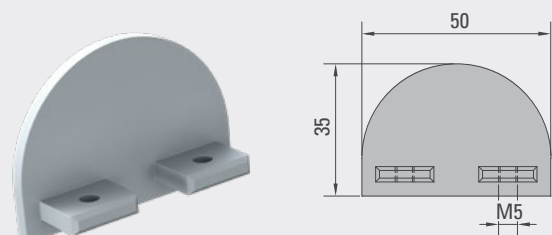

Washer

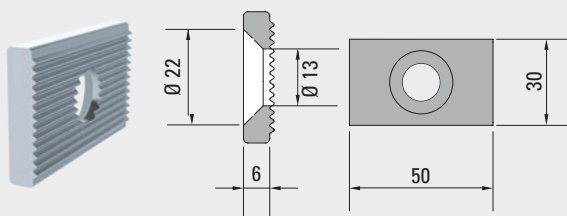

Connector

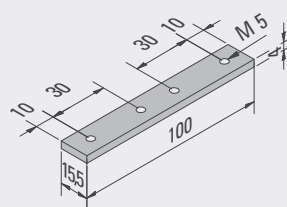

Corner connector

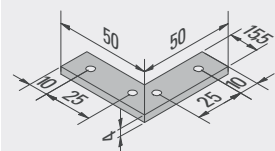

Top 1

from Top

Installation from on top

Structure connection
from above

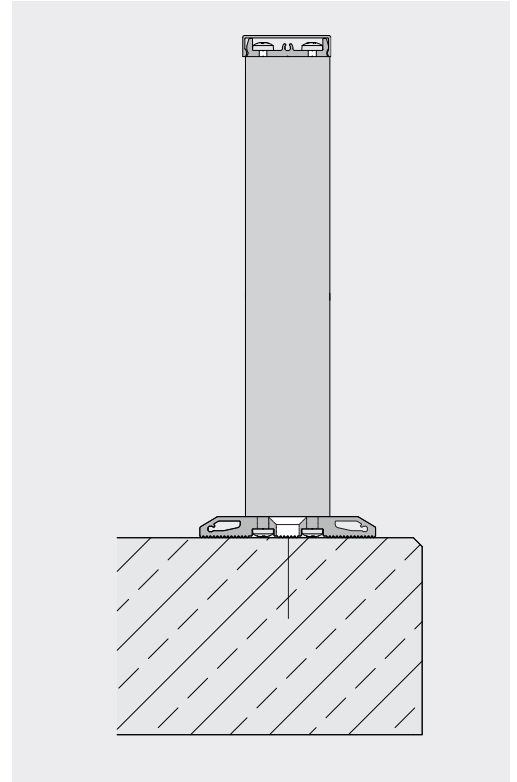
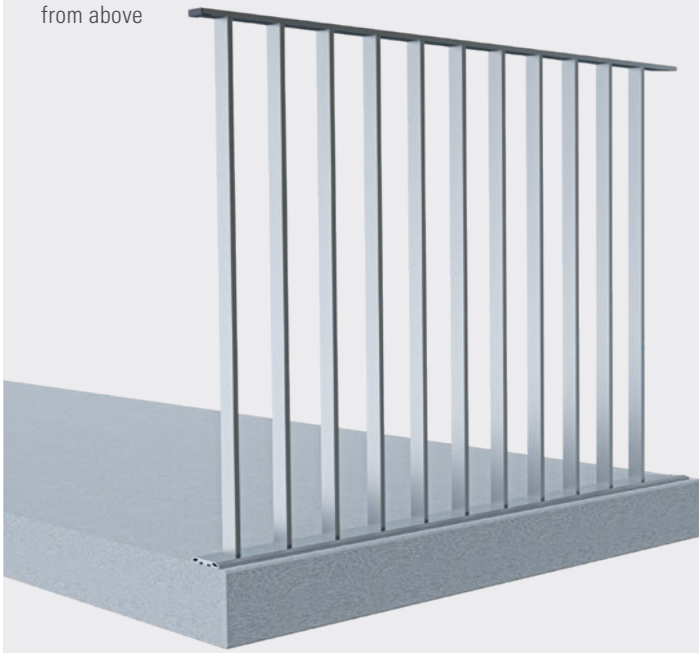

Base profile with cover plate

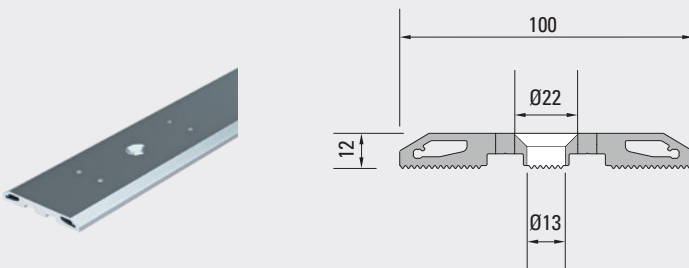

End plate for base profile

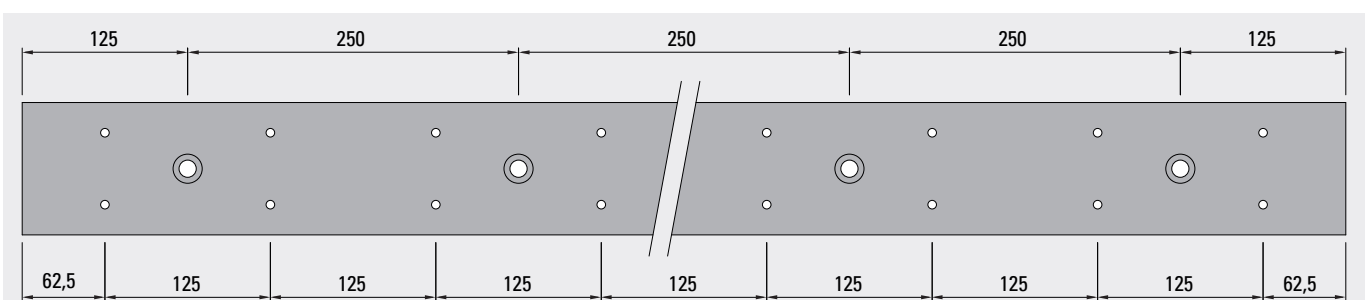

System components

Rectangular handrail

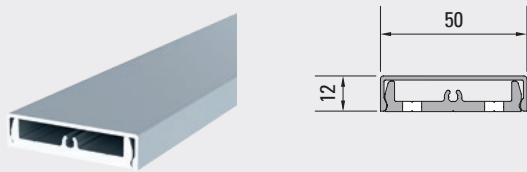

Semicircular handrail

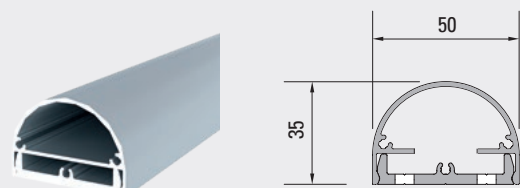

Rectangular railing rod



Semicircular railing rod

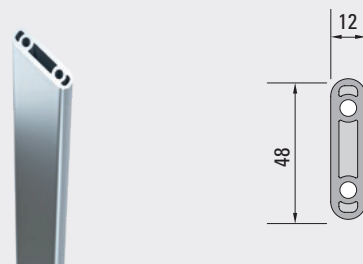

End plate for rectangular handrail

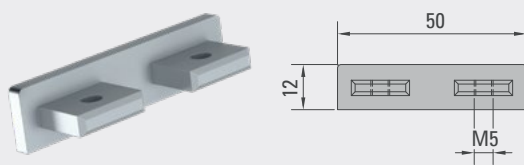

End plate for semicircular handrail

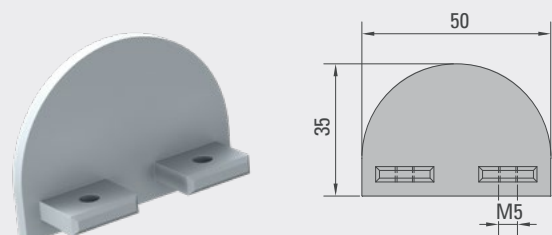

Connector

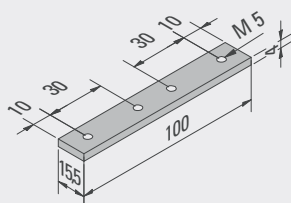

Corner connector

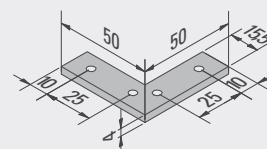

Application and dimension tables

	Rail load [KN/m]	0.5	1.0
Side 1 top	Anchor spacing [mm]	500	
	Max. Rod height [mm]	1,300	
Side 1 bottom	Anchor spacing [mm]	500	250
	Max. Rod height [mm]	1,300	1,200
Top 1	Anchor spacing [mm]	500	250
	Max. Rod height [mm]	1,300	1,200

The values apply to Fischer ULTRACUT FBS II 10x120 65/55/35 SK R (A4) concrete screw
 Anchoring depth_{heff} ≥ 68 mm
 Relining max. 22 mm

GLASSLINE

BALUGA *easy*



Installation instructions

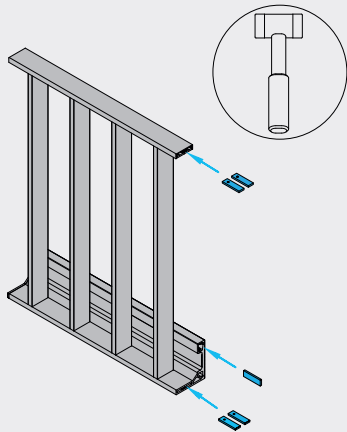

1 Hammer in the connector.

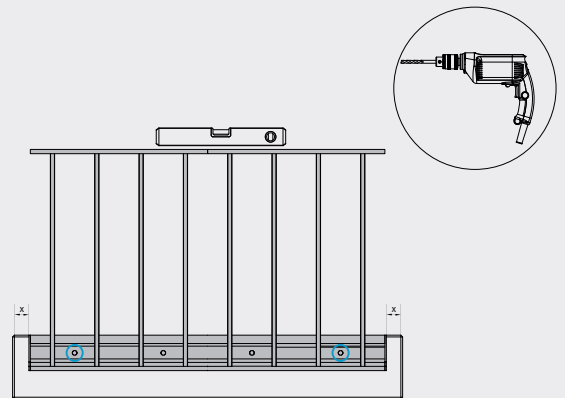

2 Align the module with the water spirit level.
Mark boreholes. Drill boreholes.

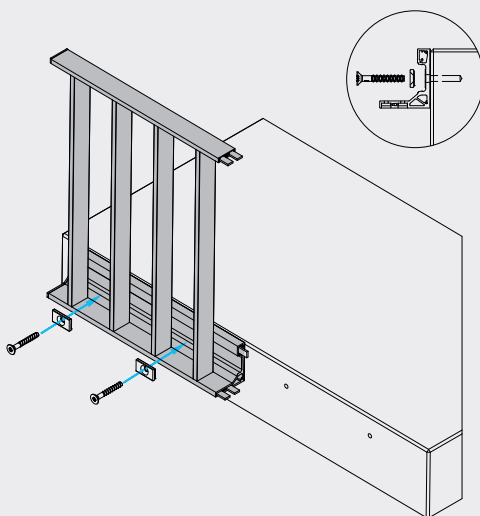

3 Fasten the module to the building structure
using a washer and suitable
attachment elements.

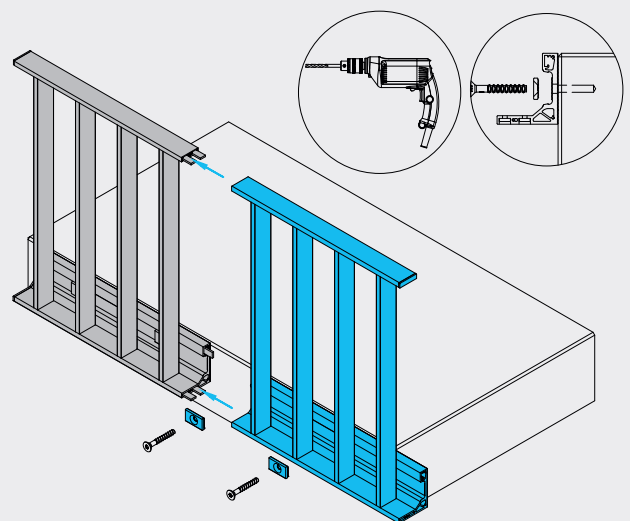

4 Connect another module.
Fasten the module to the building structure
using a washer and suitable
attachment elements.

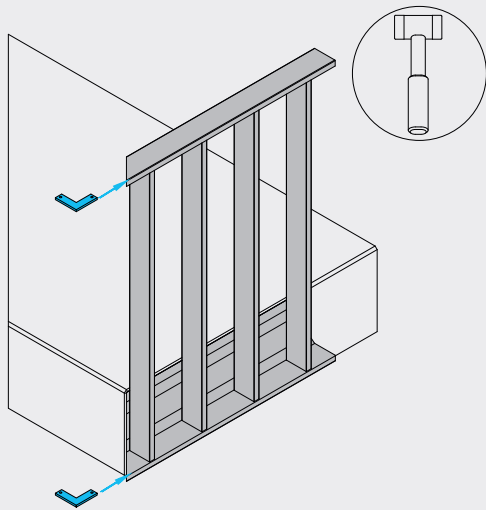

5 Corner design:
Hammer in the connector.

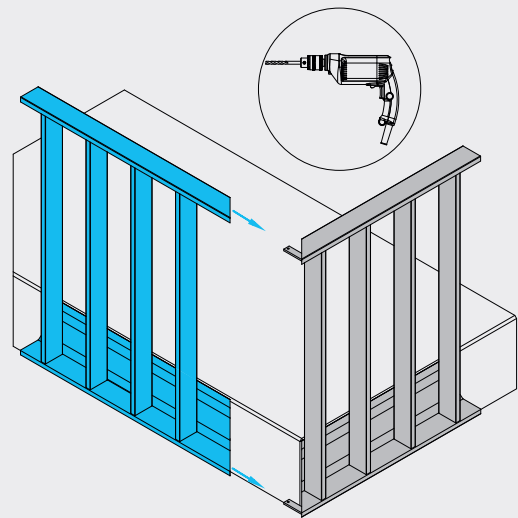

6 Corner design:
Connect module.
Fasten module to building structure with washer
and suitable attachment elements

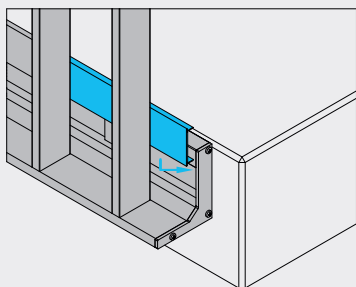

7 Clip in the plate cover.

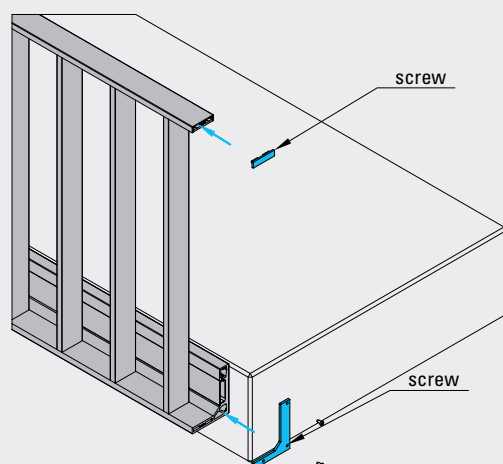

8 End plate mounting:
Screw the handrail end plate with the M5 headless pin.
Screw in the base profile end plate with a
4.2 x 16 mm sheet metal screw.

GLASSLINE

GLASSLINE GmbH

Industriestraße 7-10
74740 Adelsheim, Germany
Phone: +49 (0) 6291 6259-0
Fax: +49 (0) 6291 6259-11
info@glassline.de
www.glassline.de

System solutions for sophisticated, frameless glass architecture and safe attachment of add-on pieces to thermal insulation systems.

As a leading supplier, GLASSLINE develops, manufactures and markets high-quality system solutions in the areas of point fixing systems, all-glass railing systems, frameless canopy constructions and systems with thermal break for the secure fixing of add-on elements to building envelopes.

Copyright 2023 by GLASSLINE GmbH - Edition March 2023 - Subject to technical changes
We assume no liability for printing errors and mistakes.

- All drawings are example applications. GLASSLINE assumes no warranty or liability for any transferable applications.
- We reserve the right to make technical and design changes.
- All screw connections are durable, e. g. secured against loosening, such as through gluing.
- Object-specific application as well as the verifications of load introduction and transfer must be checked and carried out by the customer.

